

AlphaRod® Coupling

Dimensions:

Full Size:

Nominal Size	Units	OD	Lc* (min)	Lwfa	Weight
5/8"	in	1.5	4	1.252	1.17 lb (0.53 kg)
	mm	38.1	101.6	31.8	
3/4"	in	1.625	4	1.252	1.4 lb (0.63 kg)
	mm	41.3	101.6	31.8	
7/8"	in	1.811	4	1.252	1.72 lb (0.78 kg)
	mm	46	101.6	31.8	
1"	in	2.189	4	1.5	2.67 lb (1.21 kg)
	mm	55.6	101.6	38.1	
1 1/8"	in	2.375	4.5	1.5	3.29 lb (1.49 kg)
	mm	60.3	114.3	38.1	

Slim Hole:

Nominal Size	Units	OD	Lc* (min)	Lwfa	Weight
5/8"	in	1.252	4	-	0.66 lb (0.3 kg)
	mm	31.8	101.6	-	
3/4"	in	1.5	4	-	1.05 lb (0.48 kg)
	mm	38.1	101.6	-	
7/8"	in	1.626	4	-	1.14 lb (0.52 kg)
	mm	41.3	101.6	-	
1"	in	2	4	-	1.95 lb (0.88 kg)
	mm	50.8	101.6	-	
7/8" plus	in	1.705	4	-	1.48 lb (0.67 kg)
	mm	43.3	101.6	-	

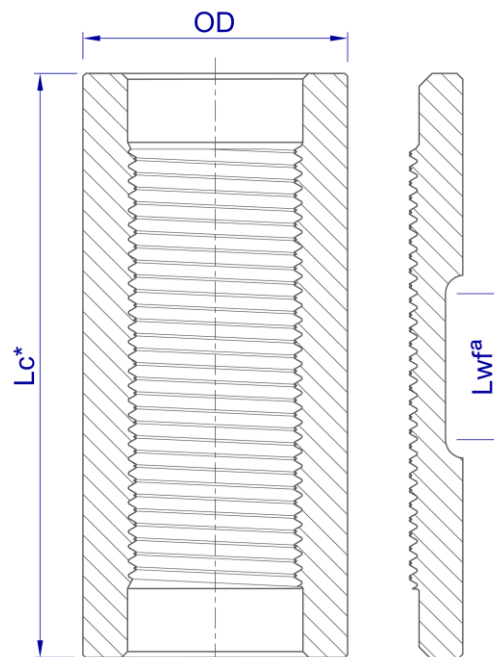

*Other lengths might be available.
^aWrench flats optional.

Steel Grades:

Chemical Composition:

Typical chemical compositions (wt%) listed in the following table.

Grade	C (%)	Mn (%)	Si (%)	S (%)	P (%)	Cr (%)	Ni (%)	Mo (%)	Other (%)
AlphaRod® HS	0.23	0.55	0.25	0.01 max	0.01 max	0.95	0.30 max	0.70	B: 0.01 max, Ti: 0.1 max, Nb: 0.1 max
AlphaRod® CS	0.23	0.55	0.25	0.01 max	0.01 max	0.95	0.30 max	0.70	B: 0.01 max, Ti: 0.1 max, Nb: 0.1 max

Mechanical Properties:

Mechanical properties are listed in the following table.

Grade	Yield Strength (0.2% offset)	Ultimate Tensile Stress	Hardness
AlphaRod® HS	Min 125 kpsi (Min 862 MPa)	145 to 160 kpsi (1000 to 1103 MPa)	32-36 HRC
AlphaRod® CS	90 to 115 kpsi (621 to 793 MPa)	100 to 130 kpsi (689 to 896 MPa)	20-28 HRC

Other Technical Data:

All the dimensions comply with API 11B, except for the OD in the 7/8" plus SH coupling.

Marking:

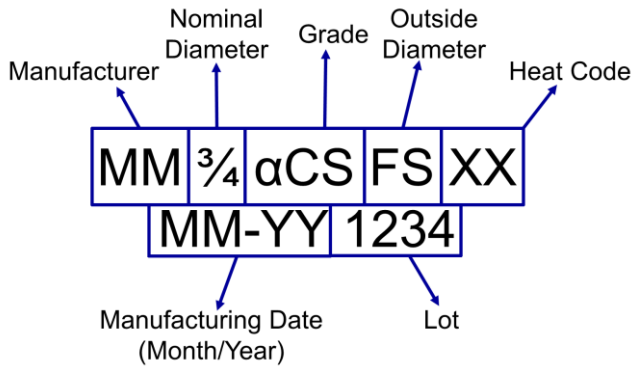

Non Destructive Testing:

All raw material is carefully inspected using electromagnetic and/or ultrasonic methods to ensure the soundness of the final product.

Labeling:*

		Metalmecánica S.A. Ruta 55 Km. 754,1 Villa Mercedes (San Luis) Made in Argentina	
		BOX N° 60000006	
PRODUCT:			
SPECIFICATION:			
QTY:	DATE:		
DIAM 1: (in)	DIAM 2: (in)		
CLASS:	TYPE:		
CLIENT:			
SALES ORDER:			
DESTINATION:			NET WEIGHT: (kg)

*Image for reference only

Ordering Information:

When placing an order please attach the following information:

- PDS:** SRCSRAR
- Coupling Type:** Coupling
- Nominal dimension:** 1"
- Size:** Full Size
- Grade:** AlphaRod® CS

Tenaris has issued this document for general information only, and the information in this document is not intended to constitute professional or any other type of advice or recommendation and is provided on an "as is" basis. No warranty is given. Tenaris has not independently verified any information –if any- provided by the user in connection with, or for the purpose of, the information contained hereunder. The use of the information is at user's own risk and Tenaris does not assume any responsibility or liability of any kind for any loss, damage or injury resulting from, or in connection with any information contained hereunder or any use thereof. The information in this document is subject to change or modification without notice. Tenaris's products and services are subject to Tenaris's standard terms and conditions or otherwise to the terms resulting from the respective contracts of sale or services, as the case may be. Unless specifically agreed under such contract of sale or services, if Tenaris is required to provide any warranty or assume any liability in connection with the information contained hereunder, any such warranty or liability shall be subject to the execution of a separate written agreement between petitioner and Tenaris. For more complete information please contact a Tenaris's representative or visit our website at www.tenaris.com. All rights reserved. ©Tenaris 2018.