

Spray Metal API Sucker Rod Coupling

Dimensions:

Full Size:

Nominal Size	Units	OD	Lc* (min)	Lwfa	Weight
5/8"	in	1.500	4.000	1.252	1.17 lb
	mm	38.1	101.6	31.8	(0.530 kg)
3/4"	in	1.625	4.000	1.252	1.4 lb
	mm	41.3	101.6	31.8	(0.633 kg)
7/8"	in	1.811	4.000	1.252	1.72 lb
	mm	46.0	101.6	31.8	(0.781 kg)
1"	in	2.189	4.000	1.500	2.67 lb
	mm	55.6	101.6	38.1	(1.209 kg)
1 1/8"	in	2.375	4.500	1.500	3.29 lb
	mm	60.3	114.3	38.1	(1.494 kg)

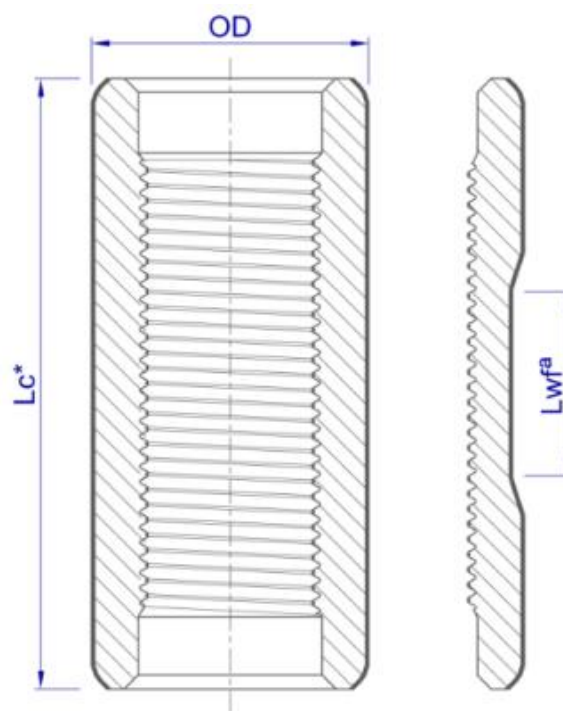

*Other lengths might be available.
aWrench flats optional.

Slim Hole:

Nominal Size	Units	OD	Lc* (min)	Lwfa	Weight
5/8"	in	1.252	4.000	-	0.66 lb
	mm	31.8	101.6	-	(0.300 kg)
3/4"	in	1.500	4.000	-	1.05 lb
	mm	38.1	101.6	-	(0.478 kg)
7/8"	in	1.626	4.000	-	1.14 lb
	mm	41.3	101.6	-	(0.519 kg)
1"	in	2.000	4.000	-	1.95 lb
	mm	50.8	101.6	-	(0.883 kg)
1 1/8"	in	2.258	4.500	-	2.74 lb
	mm	57.4	114.3	-	(1.244 kg)

Steel Grades:

Chemical Composition:

Typical chemical compositions (wt%) are listed in the following table.

Grade	C	Mn	Si	S	P	Cr	Ni	Mo	Others
TC carbon	0.26-0.35	1.25-1.55	0.15-0.35	0.025 max	0.025 max	0.55 max	0.15 max	0.25 max	-

Mechanical Properties:

Mechanical properties are listed in the following table.

Grade	Yield Strength	Ultimate Tensile Stress	Hardness
TC carbon	65 to 95 kpsi (448 to 655 MPa)	95 to 125 kpsi (655 to 861 MPa)	56-62 HRA

Coating:

API Spray Metal

In accordance with API 11B

Thickness: 0.01-0.02 in (0.25-0.51 mm)

Max. Roughness (Ra): 40 µin (1.016 µm)

Hardness: 595 HV200 min

Chemical Composition:

Typical chemical compositions (wt%) are listed in the following table.

Coating	C	Si	P	S	Cr	B	Fe	Ni	Others
API Spray Metal	0.50-1.00	3.50-5.50	0.02 max	0.02 max	12.00-18.00	2.5-4.50	3.00 - 5.00	Remainder	Ti: 0.05 max Al: 0.05 max Zr: 0.05 max Co: 0.10 max

Other Technical Data:

All the dimensions comply with API 11B, except for the OD in the 1 1/8" SH.

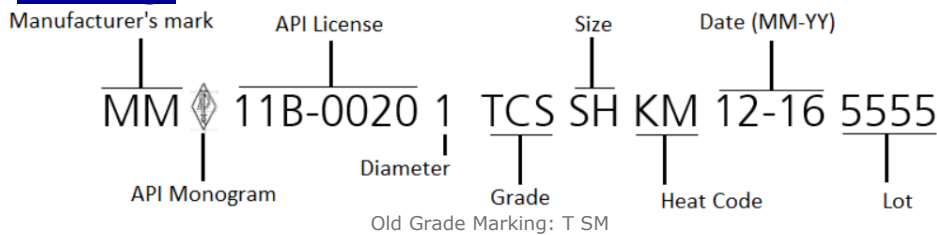

Marking:



Non Destructive Testing:

All raw material is carefully inspected using electromagnetic and/or ultrasonic methods to ensure the soundness of the final product.

Labeling:*

		Metalmecánica S.A. Ruta 55 Km. 754,1 Villa Mercedes (San Luis) Made in Argentina	
BOX N° 60000006			
PRODUCT:			
SPECIFICATION:			
QTY:	DATE:		
DIAM 1: (in)	DIAM 2: (in)		
CLASS:	TYPE:		
CLIENT:			
SALES ORDER:		NET WEIGHT: (kg)	
DESTINATION:			

*Image for reference only

Ordering Information:

When placing an order please attach the following information:

PDS: SRCSRAPISM
Coupling Type: Coupling
Nominal dimension: 1"
Size: Slim Hole
Grade: TC carbon
Coating technology: API Spray Metal

Tenaris has issued this document for general information only, and the information in this document is not intended to constitute professional or any other type of advice or recommendation and is provided on an "as is" basis. No warranty is given. Tenaris has not independently verified any information –if any- provided by the user in connection with, or for the purpose of, the information contained hereunder. The use of the information is at user's own risk and Tenaris does not assume any responsibility or liability of any kind for any loss, damage or injury resulting from, or in connection with any information contained hereunder or any use thereof. The information in this document is subject to change or modification without notice. Tenaris's products and services are subject to Tenaris's standard terms and conditions or otherwise to the terms resulting from the respective contracts of sale or services, as the case may be. Unless specifically agreed under such contract of sale or services, if Tenaris is required to provide any warranty or assume any liability in connection with the information contained here under, any such warranty or liability shall be subject to the execution of a separate written agreement between petitioner and Tenaris. For more complete information please contact a Tenaris's representative or visit our website at www.tenaris.com. All rights reserved. ©Tenaris 2024