

Wedge 623[®] connection

API 5C5 CAL-IV Compliant | 9 5/8" TO 16 1/2"

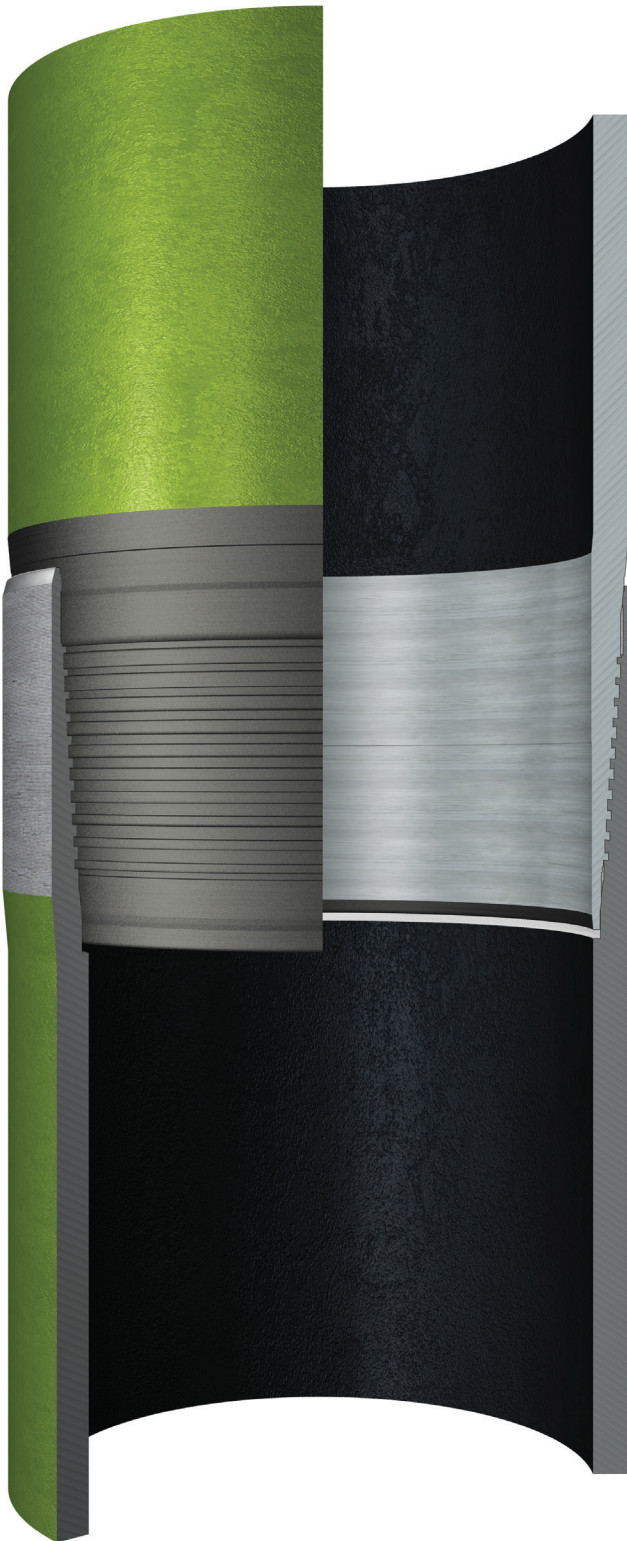

The TenarisHydril Wedge 623[®] connection was developed to comply with recent changes in deepwater operating requirements in the Gulf of Mexico. The new connection is an improved version of the Wedge 523[®] connection design featuring an additional external metal-to-metal seal and offering unmatched compression ratings (70-75% efficiency) in an integral connection.

The TenarisHydril Wedge 623[®] connection offers all the advantages of the TenarisHydril Wedge technology together with metal sealing performance capabilities and compression ratings that make it suitable for the most severe deepwater and high pressure applications. It is compliant with the API 5C5 CAL-IV testing protocol and in line with API RP96 criteria.

The connection comes with our Dopeless[®] technology, which enhances its performance and reliability and provides additional operational, well productivity and HSE benefits.

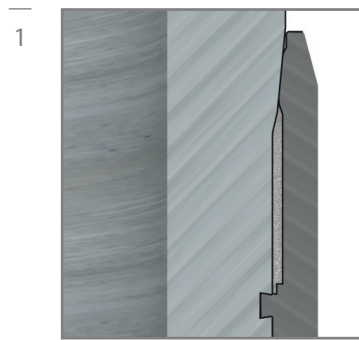
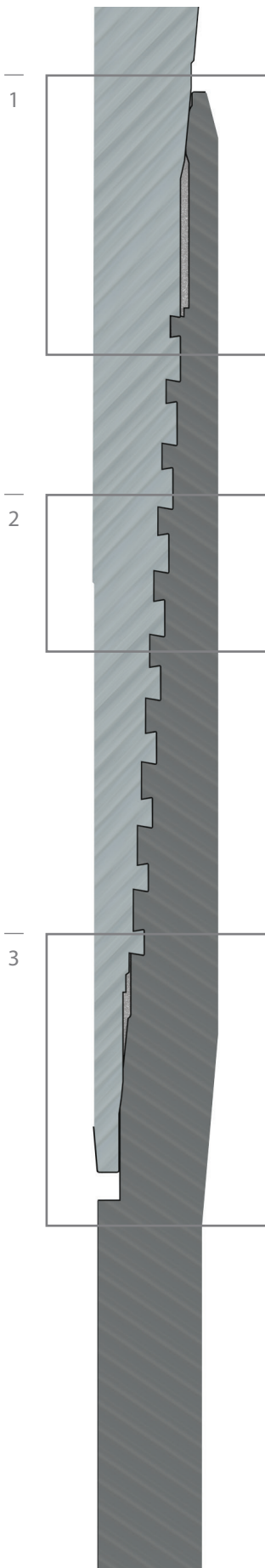

- 100% external pressure seal for added reliability.
- Clearance OD 1.5 – 2% of specified nominal pipe body OD for high clearance applications.

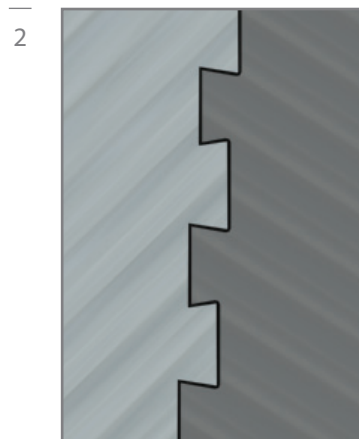

- Exceptional torque capability and compression efficiency developed through the simultaneous engagement of opposing flanks of the dovetail thread.
- No drift restrictions after over torque.
- Unrivalled running reliability and robustness given by the Wedge thread.

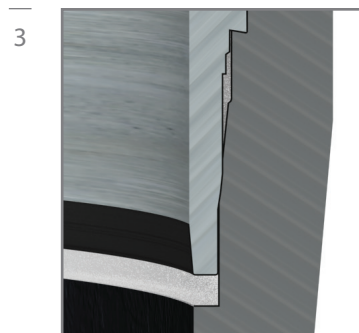

- 100% internal pressure rated metal seal maintains gas sealing capability under high axial loads.
- Patented seal saver protects pin seal from handling damage and acts as a stiffener to improve metal seal functioning.

MAIN FEATURES

- Internal and external pressure seals (metal-to-metal) in line with API RP96 for deepwater applications.
- Outstanding compression efficiency of 70 to 75%, equivalent to the performance of TenarisHydril Wedge 523® connection.
- Tested under the API 5C5 CAL-IV testing protocol, the Wedge 623® Dopeless® connection provides validated reliability under combined loads.
- Comes with Dopeless® technology.

MAIN APPLICATIONS

- Offshore/Deepwater
- HP/HT and deep wells
- Intermediate casing
- Liners and tie-backs

For further information please contact premiumconnections@tenaris.com