

HolloRod™ Check Valve 486 SEC NU

Dimensions:

Pin 486 SEC NU - Box 486 SEC NU

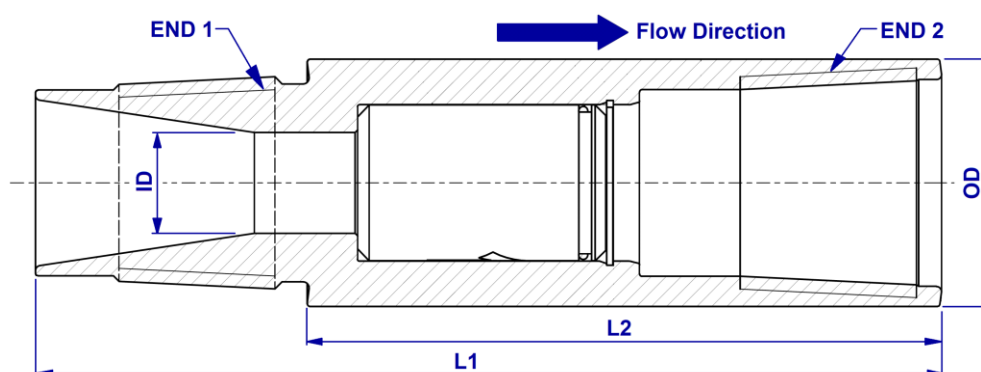

End Combination	OD	ID	L1	L2	Nominal Weight
Pin 486 SEC NU HI - Box 486 SEC NU	1.929" (49 mm)	0.709" (18 mm)	7.087" (180 mm)	4.961" (126 mm)	3.01 lb (1.37 kg)
Pin 486 SEC NU LI - Box 486 SEC NU	1.929" (49 mm)	0.787" (20 mm)	7.087" (180 mm)	4.961" (126 mm)	3.01 lb (1.37 kg)

*It can be used both as surface or downhole check valve.

Steel Grades:

Chemical Composition:

Typical chemical compositions (wt%) listed in the following table.

Grade	C (%)	Mn (%)	Si (%)	S (%)	P (%)	Cr (%)	Ni (%)	Mo (%)	Others (%)
CS105	0.23	0.55	0.25	0.010 max	0.015 max	0.95	0.30 max	0.70	V: 0.10 max
HS147	0.23	0.55	0.25	0.010 max	0.015 max	0.95	0.30 max	0.70	V: 0.10 max

Mechanical Properties:

Mechanical properties are listed in the following table.

Grade	Tensile			Toughness	Hardness
	Yield Strength (0,2% offset)	Ultimate Tensile Strength	Elongation (2")	CVN@RT Full Size	
CS105	100 to 115 kpsi (690 to 793 MPa)	Min 105 kpsi (Min 724 MPa)	10% Min	Min: 74 lb.ft (100 J)	28 HRC Max
HS147	139 to 160 kpsi (960 to 1100 MPa)	Min 147 kpsi (Min 1015 MPa)	10% Min	Min: 37 lb.ft (50 J)	32-38 HRC

Cartridge Specifications

Cartridge	Material	O-Ring	Opening Pressure	Recommended Working Pressure	Max. Temperature
K2212D-18	303 Stainless Steel	Viton	65 psi (448 kPa)	3000 psi (21 MPa)	399°F (204°C)

Performance Data:

End Combination	ID	Body Grade	HolloRod™ Grade	Make Up Torque	Max. Pulling Force	Max. Operative Torque
Pin 486 SEC NU HI - Box 486 SEC NU	18 mm	CS105	CS105	1300 to 1400 lb.ft (1763 to 1898 N.m)	81.6 klb (37 Tn)	1300 lb.ft (1763 N.m)
Pin 486 SEC NU HI - Box 486 SEC NU	18 mm	HS147	HS147	1500 to 1600 lb.ft (2034 to 2169 N.m)	103 klb (47 Tn)	1500 lb.ft (2034 N.m)
Pin 486 SEC NU LI - Box 486 SEC NU	20 mm	CS105	CS105	900 to 1000 lb.ft (1220 to 1356 N.m)	81.6 klb (37 Tn)	800 lb.ft (1085 N.m)
Pin 486 SEC NU LI - Box 486 SEC NU	20 mm	HS147	HS147	1100 to 1200 lb.ft (1491 to 1627 N.m)	115 klb (52 Tn)	1000 lb.ft (1356 N.m)

Non Destructive Testing:

All raw material is carefully inspected using electromagnetic and/or ultrasonic methods to ensure the soundness of the final product.

Each valve is inspected on a test bench using counterpressures up to 4500 psi to verify it's sealability.

Marking:

Products are marked for it's proper identification and traceability using laser engraving or die punching at manufacturer's option.

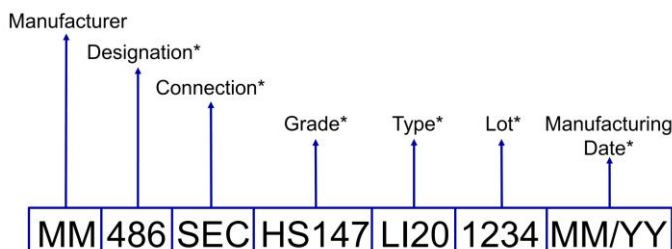

*Values shown are for reference only

Labeling:

		Metalmecánica S.A. Ruta 55 Km. 754,1 Villa Mercedes (San Luis) Made in Argentina	
		BOX N° 00000	DATE: 07/17
PRODUCT:			
PRODUCT DATASHEET CODE:			
PRODUCT DATASHEET NAME:			
GRADE			
QTY:			
CLIENT:			
SALES ORDER:		NET WEIGHT: (kg)	
DESTINATION:			

Ordering Information:

When placing an order please attach the following information:

PDS: HRCV486SECNU
End Combination: Pin 486 SEC NU HI - Box 486 SEC NU
Cartridge: K2212D-18

Tenaris has issued this document for general information only, and the information in this document is not intended to constitute professional or any other type of advice or recommendation and is provided on an "as is" basis. No warranty is given. Tenaris has not independently verified any information -if any- provided by the user in connection with, or for the purpose of, the information contained hereunder. The use of the information is at user's own risk and Tenaris does not assume any responsibility or liability of any kind for any loss, damage or injury resulting from, or in connection with any information contained hereunder or any use thereof. The information in this document is subject to change or modification without notice. Tenaris's products and services are subject to Tenaris's standard terms and conditions or otherwise to the terms resulting from the respective contracts of sale or services, as the case may be. Unless specifically agreed under such contract of sale or services, if Tenaris is required to provide any warranty or assume any liability in connection with the information contained hereunder, any such warranty or liability shall be subject to the execution of a separate written agreement between petitioner and Tenaris. For more complete information please contact a Tenaris's representative or visit our website at www.tenaris.com. All rights reserved. ©Tenaris 2017.